

# FINGERSAFE MK1A & MK1B

## FITTING INSTRUCTIONS

[www.fingersafe.com.au](http://www.fingersafe.com.au)

21-25 Coora Road, Oakleigh South, VIC 3167

Tel: +61 3 9885 8009

Email: [enquiry@fingersafe.com.au](mailto:enquiry@fingersafe.com.au)

Fingersafe is easy to fit and very reliable when installed correctly. It is essential that these instructions are followed carefully. We can accept no liability or responsibility for incorrect installation. Fingersafe can be installed in 95% of today's doors, however make sure that your door is not one of the following types; double swing doors; doors with rising or declining butt hinges; sliding doors. If your door is one of these, please contact us for assistance.

### Tools required for fitting Fingersafe

- 1) Cordless drill (or screwdriver)
- 2) Stanley knife (always keep the blade sharp)
- 3) Strong scissors or tinsnips
- 4) Posidrive bit
- 5) Pencil
- 6) Self-drilling screws for wood, metal & aluminium doors (provided)

*The screws provided for installation are for wood and metal; if installing in wood, make sure the electric screwdriver is set to a low tension.*

### COMPONENTS OF FINGERSAFE

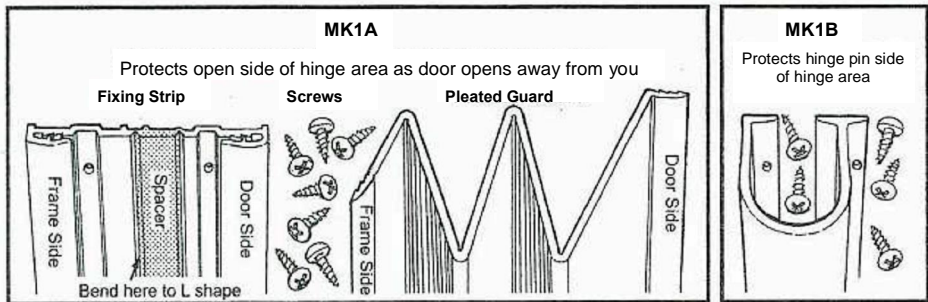

- 1 Check the stability of the door and hinges by opening the door at a 45 degree angle and gently but firmly exerting lateral and vertical pressure. This will show any instability or damage in the door or frame which must be repaired before you start. If the door has a closer attachment, you must check its effectiveness. If the door closes easily without Fingersafe, it will continue to do so once Fingersafe is installed.
- 2 After any necessary door maintenance, bring all the tools to the side of the door that swings away from you, and pull the door closed tight.
- 3 Measure from the bottom of the door to the bottom side of the frame at the top. Subtract 3/4 inch (20 mm) for clearance and cut the fixing strip and pleated panel square to length if necessary.

**NO LIABILITY WHATSOEVER ACCEPTED IF THESE INSTRUCTIONS ARE NOT FOLLOWED**

# MK1A Installation instructions for standard hinged door

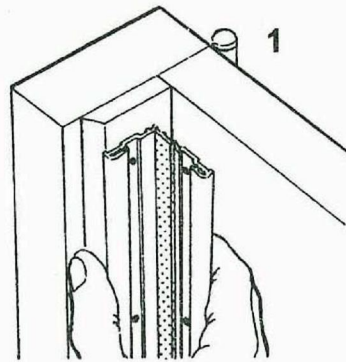
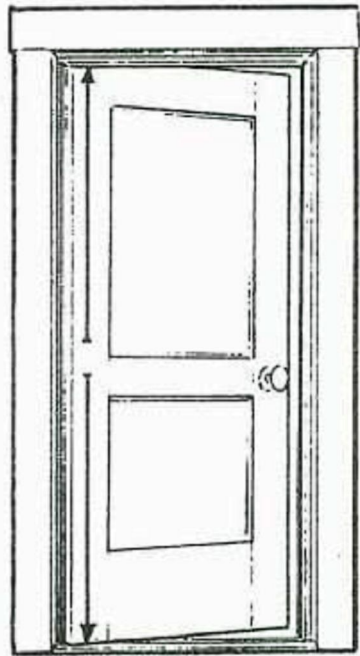

When bent, hold corner of L firmly in corner of frame and door. Align with bottom of door

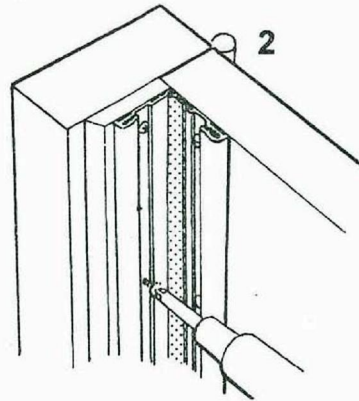

Insert TEK screws on alternating sides, keeping corners firmly in place

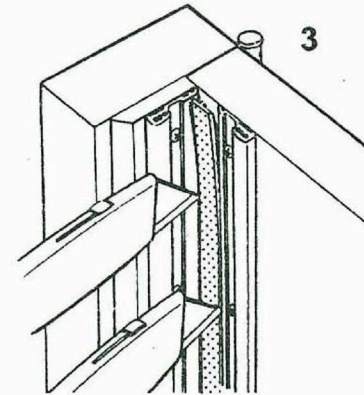

With Stanley knife separate strips at corner and remove spacer

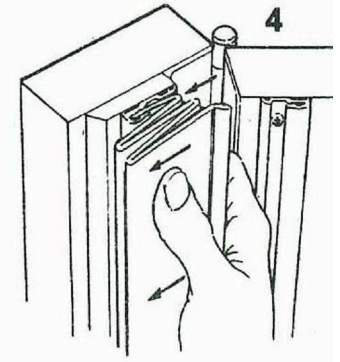

Open door 90 degrees and align 1 inch side of pleated panel to frame fixing strip. Snap in position top to bottom

## Fitting Tips

After installing fixing strip, the 1 inch panel must be snapped into frame fixing strip **FIRST**. See No. 4.

When snapping the fingersafe panels in position, 3 distinct clicks per side signal a complete installation.

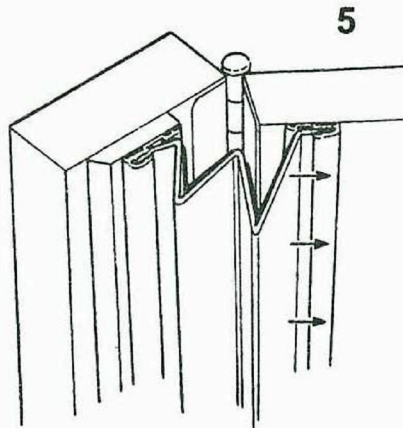

Insert 3 inch panel of fingersafe in door fixing strip

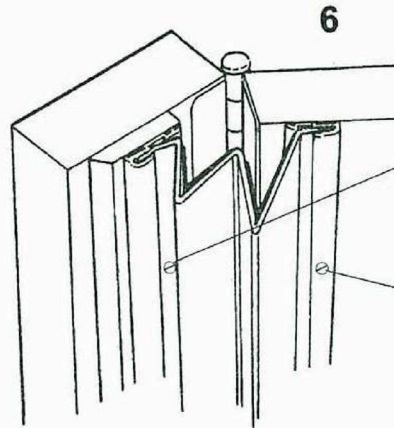

Add TEK screws through both fixing strip and fingersafe

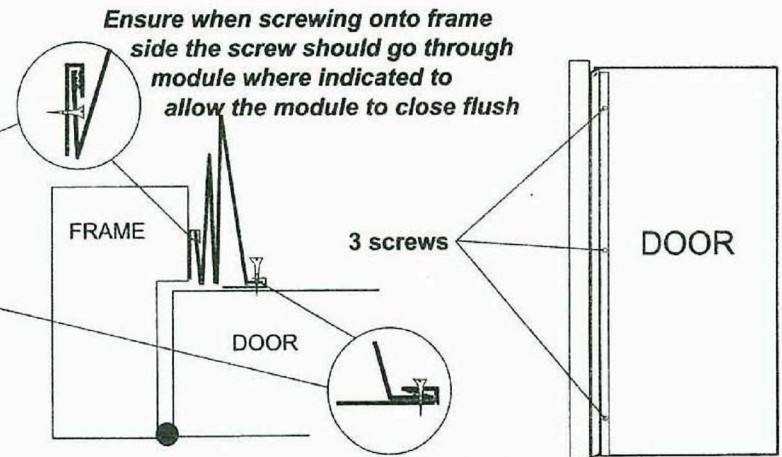

BIRDS EYE VIEW Shows Fingersafe fitted with the door closed

**THESE INSTRUCTIONS MUST BE FOLLOWED PRECISELY IN ORDER TO VALIDATE THE 2 YEAR GUARANTEE**

# MK1B INSTALLATION FOR STANDARD HINGED DOOR

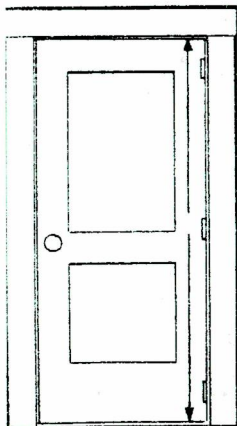

Measure height of the hinge side of door. Cut MK1B square to this length

## Fitting Tips

- (1) Both the L and T must be parallel to door and frame and each other for maximum protection and wear
- (2) The screws on the L side must be secure first for obvious reasons

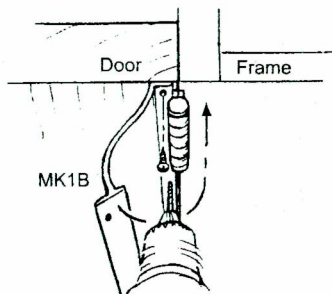

Butt L shaped edge to the door side of hinges while aligning with top and bottom of door. Secure completely with TEK self tapping screws

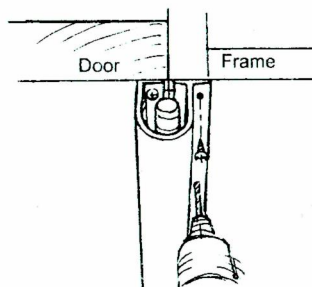

Roll the MK1B over the hinges and butt the T shape to hinges on frame side. Align with L shape top and bottom. Secure with TEK self tapping screws and remove cellophane protective membrane. You are now fingersafe

## Typical installation

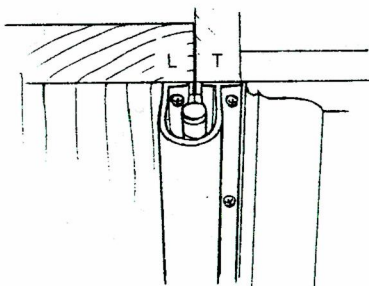

MK1B must be cut square aligned with top and bottom of door

## Exception to Typical

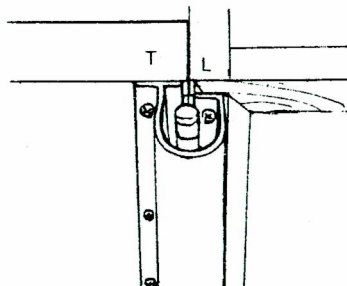

Architrave frame fitted with MK1B reversed, due to limited space on the frame side